



INSTALLATION INSTRUCTIONS
SADDLEBAG SUPPORT KIT
FOR 2004-10 XL 883 & 1200 MODELS
Mfg. p/n 110880
(See pkg. label for Dist. p/n)

ATTENTION INSTALLER (if other than owner):

Please forward this instruction sheet and the warranty card to the purchaser of this product. These instructions also contain valuable information necessary to the end user.

INTRODUCTION:

These instructions describe the procedure for properly installing KHROME WERKS® Saddlebag Support kit onto 2004-10 Harley-Davidson® XL Sportster® models. Review instructions carefully before beginning, as they contain important information. Please retain for future reference.

Particularly important information is distinguished in these instructions by the following notations:

NOTE: A NOTE provides key information to make procedures easier or clearer.

CAUTION: A CAUTION indicates special procedures that must be followed to avoid damage to the motorcycle or accessories.

WARNING: A WARNING indicates special procedures that must be followed to avoid injury or death to a motorcycle operator or person inspecting or repairing the motorcycle.

TOOLS REQUIRED:

- 1 . ¼+hex key wrench
- 1 . T50 Torx wrench
- 1 . T40 Torx wrench
- 1 . ½+combination wrench
- 1 . Torque wrench
- #242 Loctite (blue)

PROCEDURE:

CAUTION: Perform installation on one side at a time. Support motorcycle when removing shock screws.

1. Remove OEM Torx screw, washer and upper shock cover. Save screw and washer (Items 2, 3).
2. Remove OEM Torx screw directly behind upper shock screw on the chrome fender support. Save the nut.
3. Apply Loctite to the OEM shock screw (Item 2) and install through the saved washer (Item 3), front bracket on the KW saddlebag support (Item 1), shock and into the frame. Do not tighten at this time.

NOTE: If installing supports with sissy bar side plates, omit 5/16+ lock washer (Item 5).

4. Insert supplied socket head cap screw (Item 4) and lock washer (Item 5) (if applicable) through the rear saddlebag support mount, chrome fender support, frame, sissy bar side plate (if applicable) and fender. Apply Loctite to the saved nut and secure. Torque to 11-18 ft-lbs torque.

WARNING: Make sure that rear screw is fully engaged into nut, but not able to contact rear tire when rear shocks are compressed.

5. Torque front screw to 45-50 ft-lbs torque.

WARNING: Check saddlebag support clearance for proper operation of shock while suspension is compressed.

6. Repeat for other side.

WARNING: Saddlebags must be secured to the supports with straps supplied by saddlebag manufacturer. Upon initial installation ensure that no parts of the bags or the mounting straps could interfere with operation of rear belt (or chain), shocks or wheel. We recommend throw-over saddlebags be mounting securely under the seat (not thrown over it). Periodically check straps to ensure proper installation.

USE AND CARE: Wash your accessories with the same care you use when washing your motorcycle. Use mild soap and water. DO NOT use abrasive chemicals or cleaners, or high pressure washers.

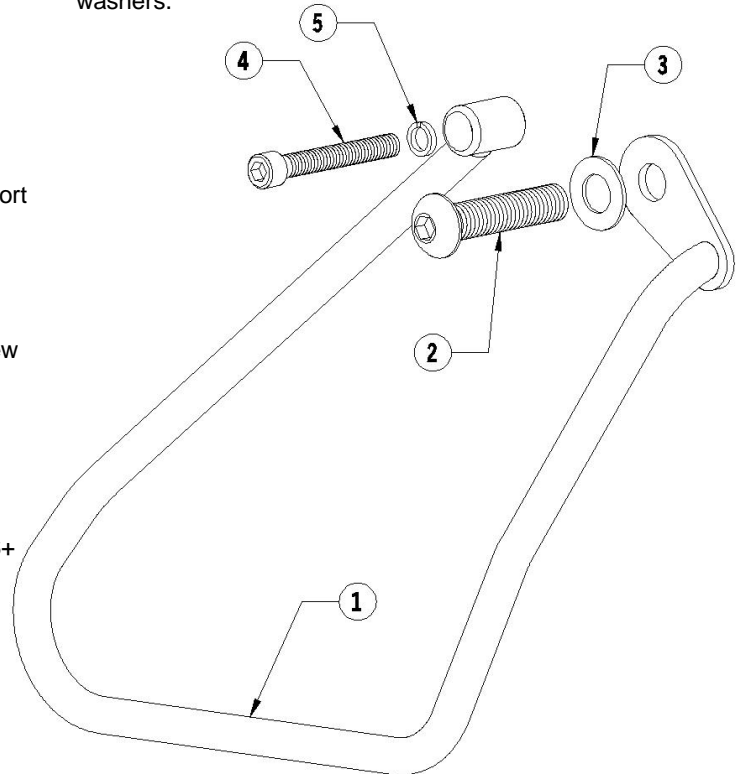

KHROME WERKS®
P.O. BOX 355 • New Prague, MN 56071