



INSTALLATION INSTRUCTIONS
SADDLEBAG SUPPORTS FOR 2006-10 FXD models
Mfg. p/n 110830
(See pkg. label for Dist. p/n)

ATTENTION INSTALLER (if other than owner):

Please forward this instruction sheet and the warranty card to the purchaser of this product. These instructions also contain valuable information necessary to the end user.

INTRODUCTION:

These instructions describe the procedure for properly installing KHROME WERKS® Saddlebag Supports on 2006-10 Dyna® FXD models (except 2008-10 FXDF). Review instructions carefully before beginning, as they contain important information. Please retain for future reference.

Particularly important information is distinguished in these instructions by the following notations:

NOTE: A NOTE provides key information to make procedures easier or clearer.

CAUTION: A CAUTION indicates special procedures that must be followed to avoid damage to the motorcycle or accessories.

WARNING: A WARNING indicates special procedures that must be followed to avoid injury or death to a motorcycle operator or person inspecting or repairing the motorcycle.

TOOLS REQUIRED:

- 1 . ½" combination wrench
- 1 . #2 Phillips screwdriver
- 1 . #45 Torx 3/8+drive socket and 3/8+driver
- 1 . 5/16+hex key 3/8+drive socket
- 1 . 3/8+drive torque wrench
- 1 . #243 Loctite thread lock

PROCEDURE:

WARNING: Disconnect negative battery cable to prevent short circuits before performing any of the following procedures.

1. Remove taillight lens.
2. Depress locking tab and disconnect both rear directional light wire plugs in the taillight housing (two wire connector with purple and black wires.)
3. Push plug and wires through taillight housing into fender well. Unhook the wires from the slip inside the fender closest to the taillight.
4. Remove and discard the OEM 3/8+16 x 1-1/8+Torx screws at the front of the chrome fender support cover just ahead of the directional signal (Item #4). A wrench inside the fender well is not required; these screws thread into a nut plate (Item #6) inside the fender. Perform one side at a time.

5. Support the directional assembly and remove the OEM 5/16+ hex head screw inside the fender. Discard the screw; save the washer.

6. Pull the directional wire and plug through the hole in the nut plate, fender and strut. The fender mounting plate (Item #6) will now be loose inside the fender and it will be reused. Note that the wires are secured to the inside of the fender away from tire contact by a formed tab on the rear end of the fender mounting plate.

NOTE: If you are installing KW Saddlebag Supports with KW Sissy Bar Side Plates additional hardware will not be required.

7. Insert the supplied 3/8+16 socket head cap screw (Item #2) through the front boss of the KW support (Item #1), fender support cover, frame strut, sissy bar side plate (if applicable), fender and into the nut plate a couple of turns. Do not tighten yet.

8. Insert the plug and wire of the directional housing through the turn signal extension, front hole in the rear boss of the KW saddlebag support, fender support cover, sissy bar side plate (if applicable), fender and the fender mounting plate.

9. Apply blue Loctite 243 to the threads of the supplied 5/16+18 x 4-½" hex head screw (Item #3). Insert screw through the OEM washer (Item #5), fender mounting plate (Item #6), sissy bar side plate (if applicable), frame strut, fender support cover, and rear KW saddlebag support boss (Item #1) from the inside of the fender and into the directional extension and housing.

NOTE: Before torquing the fastener, the wires must be secured behind the fender mounting plate tab.

10. Route the wires through the fender and into the taillight housing sockets.

NOTE: The wires may not be long enough to be secured by the rear clip. You must extend the wires and secure them under the rear clip if it appears that tire contact may be possible.

11. Torque all fasteners to 20-27 ft-lbs. within 10 minutes of applying Loctite.

12. Repeat for other side.

13. Install taillight lens.

14. Reconnect negative battery cable.

15. Test both directional lights for proper operation.

WARNING: Do not operate motorcycle with faulty directional lights. Inspect all connections and routing of wires if directional lights do not function properly.

KHROME WERKS®
P.O. BOX 355 • New Prague, MN 56071

INSTALLATION INSTRUCTIONS
SADDLEBAG SUPPORTS FOR 2006-10 FXD models
Mfg. p/n 110830
 (See pkg. label for Dist. p/n)

WARNING: Saddlebags must be secured to the supports with straps supplied by saddlebag manufacturer. Upon initial installation ensure that no parts of the bags or the mounting straps could interfere with operation of rear belt (or chain), shocks or wheel. We recommend throw-over saddlebags be mounting securely under the seat (not thrown over it). Periodically check straps to ensure proper installation.

USE AND CARE: Wash your accessories with the same care you use when washing your motorcycle. Use mild soap and water. **DO NOT** use abrasive chemicals or cleaners, or high pressure washers.

BILL OF MATERIALS

Item #	Mfg. p/n	Description	Qty.
1	110831	Saddlebag Support, Left	1
	110832	Saddlebag Support, Right	1
2	430524	Screw, sckt 3/8+16 x 1-3/4+	2
3	420475	Screw, hex 5/16+18 x 4-1/2%	2
4	OEM	Directional Housing	2
5	OEM	3/8+(5/16+) Flat washer	2
6	OEM	Fender Mounting Plate	2

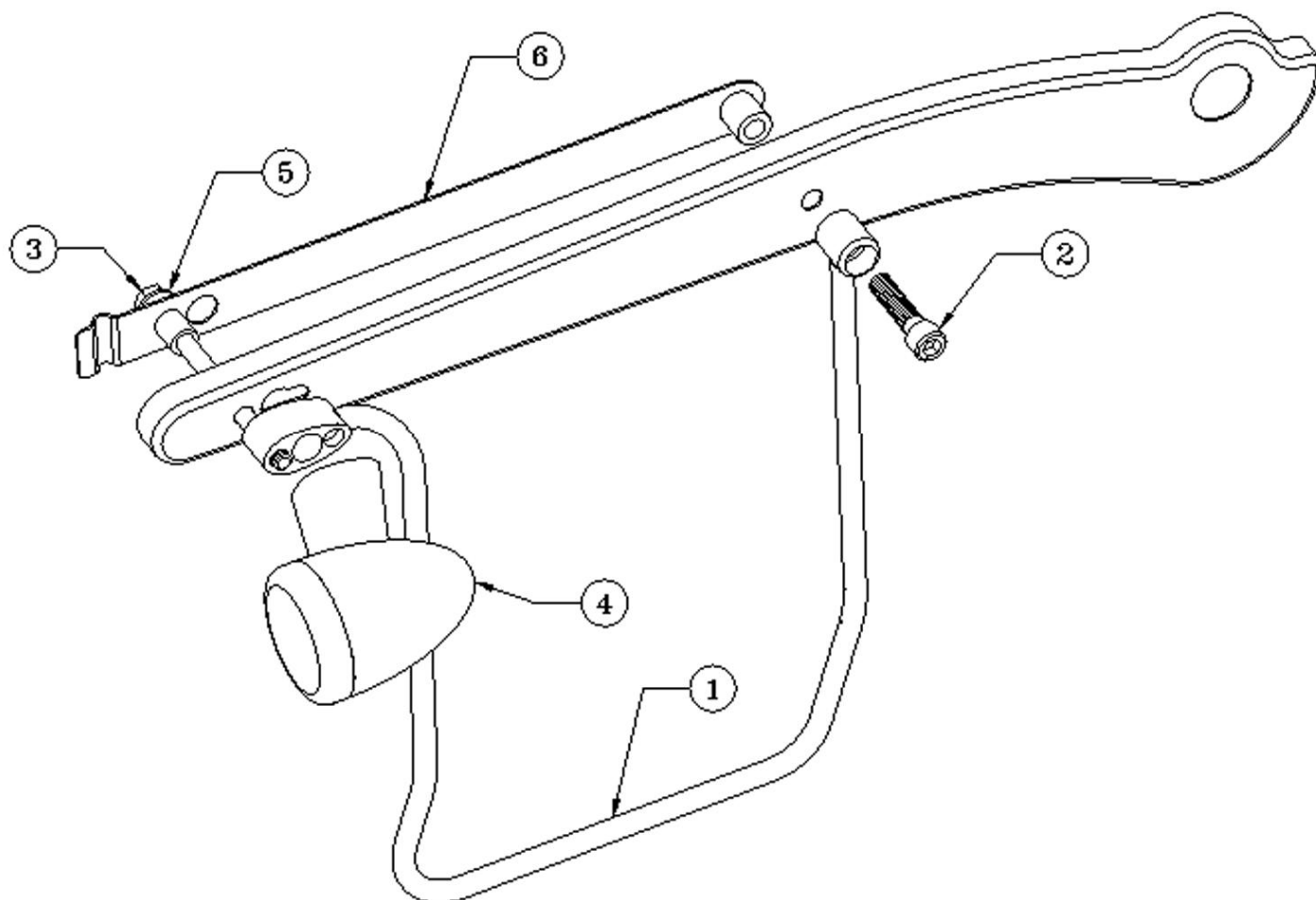

KHROME WERKS®
P.O. BOX 355 • New Prague, MN 56071