



## INSTALLATION INSTRUCTIONS

### REAR DRESSER BARS

For 1986-2010 FLST; 1986-05 FXST

Mfg. p/n 190050B

(See pkg. label for Dist. p/n)

#### ATTENTION INSTALLER (if other than owner):

Please forward this instruction sheet and the warranty card to the purchaser of this product. These instructions also contain valuable information necessary to the end user.

#### INTRODUCTION:

These instructions describe the procedure for properly installing KHROME WERKS® Rear Dresser Bars onto 1986-2005 FXST; 1986-2010 FLST models (not FLSTF or FLSTS). Review instructions carefully before beginning, as they contain important information. Please retain for future reference.

Particularly important information is distinguished in these instructions by the following notations:

**NOTE:** A NOTE provides key information to make procedures easier or clearer.

**CAUTION:** A CAUTION indicates special procedures that must be followed to avoid damage to the motorcycle or accessories.

**WARNING:** A WARNING indicates special procedures that must be followed to avoid injury or death to a motorcycle operator or person inspecting or repairing the motorcycle.

#### TOOLS REQUIRED:

- 1 . 7/16+socket key wrench
  - 1 . 3/8+socket key wrench
  - 1 . #45 Torx socket key wrench\*
  - 1 . #50 Torx socket key wrench\*
  - 2 . 1/2+combination wrenches
  - 1 . 9/16+combination wrench
  - 1 . 3/4+combination wrench
- \*2000 and later models only*

#### PROCEDURE:

**CAUTION:** Dresser Bars are designed for aesthetics only. They may provide a very small amount of protection for motorcycle in the event of a tip-over while it is parked or at a very low speed. They are not intended to provide bodily protection in any circumstances.

1. Remove hardware securing passenger footrests or floorboards.

**NOTE:** On 1986-99 models, save hardware. 2000-up models, discard hardware from foot pegs. 1990-up models equipped with OEM saddlebags, discard front saddlebag supports. 1994-up models, save rubber isolators, washer and acorn nuts.

2. Remove front fastener that secures fender to strut: 1986-99 models, remove acorn nut, bolt and seat strap, and discard.

2000-up models, remove Torx screw, seat strap and flange nut, and discard (may reuse flange nut).

3. Install new 3/8+button head screw and washer (items #3, 4) through dresser bar upper mount, strut and fender. Secure with supplied flange nut (item #5).

**NOTE:** Lower mount on Dresser Bar mounts on inside of footrest boss on frame. It is designed to mount with nothing between it and the frame. For those accessories requiring H-D bracket relocation kit, P/N 90345-90A or 90238-00, a mounting hole has been provided for saddlebag supports and this relocation kit is not required.

**WARNING:** Foot pegs must fold up at a 45° angle (from vertical) toward rear of motorcycle. This angle allows foot pegs to fold up if, by accident, they strike the ground surface when making a sharp turn. Failure to set foot pegs to the proper fold-up angle could result in death or serious injury. «

*†Harley-Davidson Motor Company July 1999*

4. Position and secure lower mount on Dresser Bar. 1986-99 models, install OEM footrest or floorboards using OEM hardware. (Or a replacement bolt or screw of the proper length. A fastener is not provided due to the variety of accessories that can be mounted in the position. See caution below.)

2000-up models, install OEM footrest using supplied 3/8+ socket head screw and flange nuts (items #6, 5).

**CAUTION:** Many accessories mount in this location. Make sure bolt/screw or stud is of adequate length to safely mount footrest/floorboard. General rule: 1 1/2 times of thread diameter engagement for blind fastening and at least one thread should be showing through nuts. Make sure fastener is not too long and that it doesn't bottom out before tightening.

5. Align Dresser Bars and tighten all hardware.

6. On 1990-93 FLSTC models equipped with saddlebags and others equipped with OEM Heritage saddlebags, supports were discarded. Attach lower front saddlebag mount using supplied 5/16+ bolt, washer, spacer, nut (items #7, 8, 9, 10). Spacer goes between support and Dresser Bar. If holes do not line up, loosen top two support bolts, realign and tighten all hardware.

1994-up models equipped with saddlebags, supports were discarded. Attach rubber isolator using OEM washers and nut and supplied 5/16+nylock nut (see illustration).

7. Repeat for other side.

**USE AND CARE:** Wash your accessories with the same care you use when washing your motorcycle. Use mild soap and water. DO NOT use abrasive chemicals or cleaners, or high pressure washers.

**KHROME WERKS®**

P.O. BOX 355 • New Prague, MN 56071



**INSTALLATION INSTRUCTIONS**  
**REAR DRESSER BARS**  
 For 1986-2010 FLST; 1986-05 FXST  
 Mfg. p/n 190050B  
 (See pkg. label for Dist. p/n)

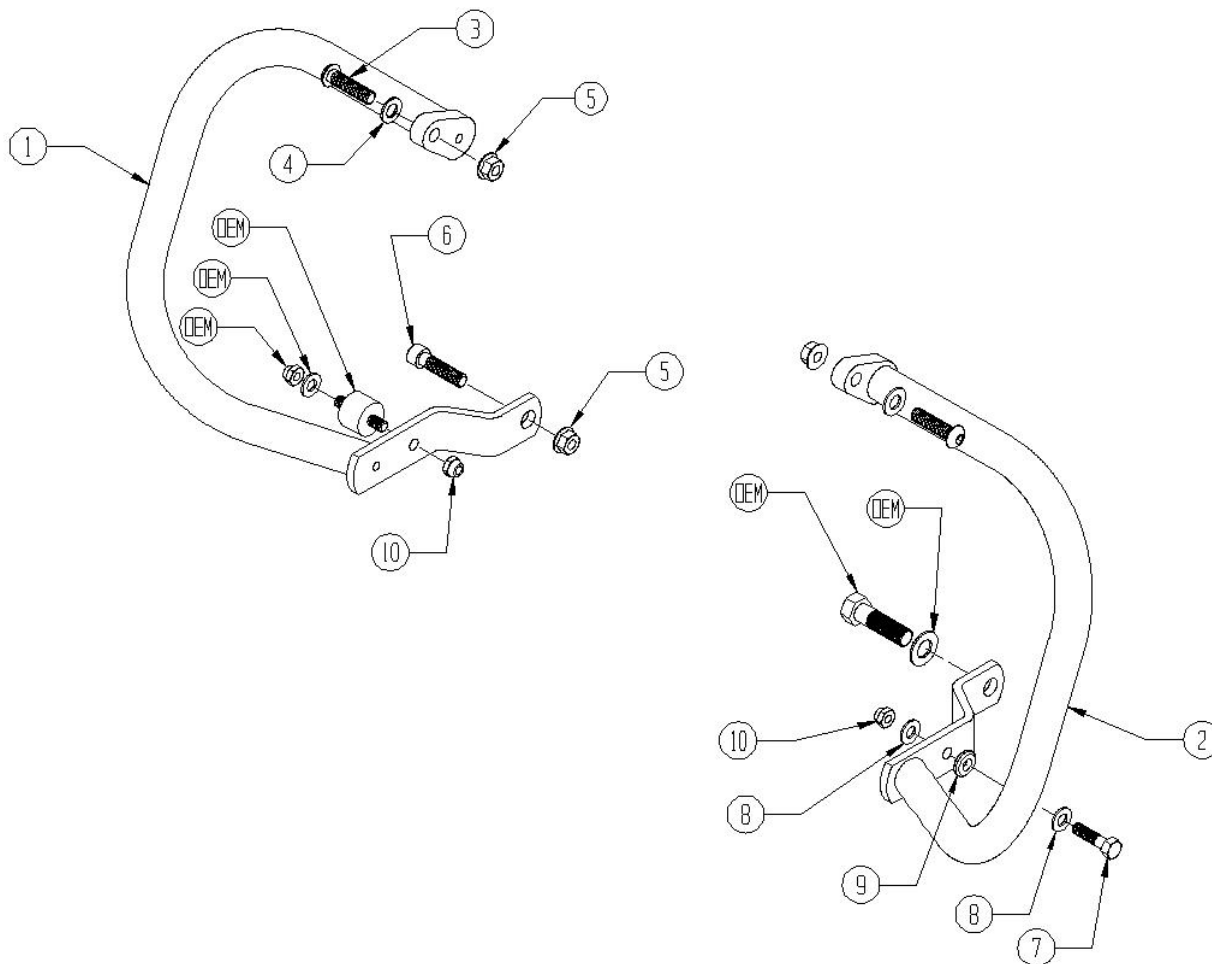

**BILL OF MATERIALS**

Item #	Mfg. P/N	Description	Qty.
1	190053	Left Dresser Bar	1
2	190054	Right Dresser Bar	1
3	433465	Screw, button head 3/8+16 x 1 3/4+	2
4	420286	Washer, 3/8+flat	2
5	420082	Nut, 3/8+16 hex flange	4
6	430529	Screw, socket head 3/8+16 x 2 1/2+	2
7	420473	Screw, hex 5/16+18 x 1 1/4+	2
8	420285	Washer, 5/16+flat	4
9	438975	Spacer, .75 o.d. x .34 i.d. x .188 l	2
10	420142	Nut, 5/16+18 hex nylock	2

**KHROME WERKS®**  
 P.O. BOX 355 • New Prague, MN 56071